

Boat Vent Installation

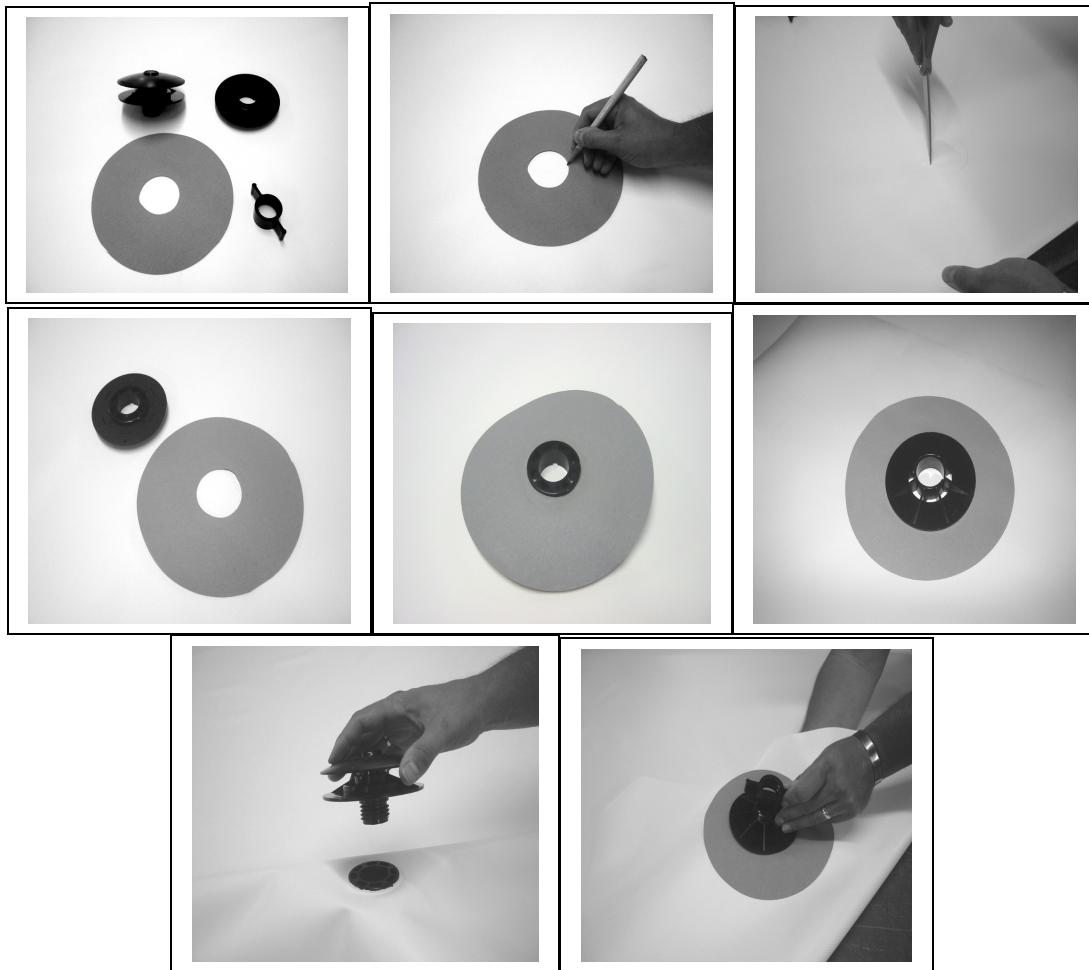

1) Unscrew wing-nut and disassemble vent.(4 pieces: large top half, lower small half, wing-nut, fabric gasket)

2) Select location on boat cover where you wish to have the boat vent located. Using the fabric gasket as a stencil, trace the 2 ½ “ circle onto boatcover and cut out

3) Place the fabric gasket on the smaller half of vent and then from the underside of cover place the smaller half through the hole cut in boatcover.

4) Insert the larger half of vent (from topside of boatcover) into the smaller half that is sticking out from the underside.

5) Replace wingnut from the underside of cover and secure snugly.

6) If prop pole is desired place the small end of pole into the bottom of vent and adjust height accordingly.